



VPC-TIP

November 26, 2001
Orientation Function

Orientation Function

During my recent travels, I discovered that some folks were not aware of the “*Orientation*” option inside the Building Editor of VPCCommand. As usual, where there are a couple of questions, there are many others that have the same questions. The “*Orientation*” function was added to the Toolbar and Menu (View / Orientation) so that you can easily rotate your building to view and/or print at any desired angle.

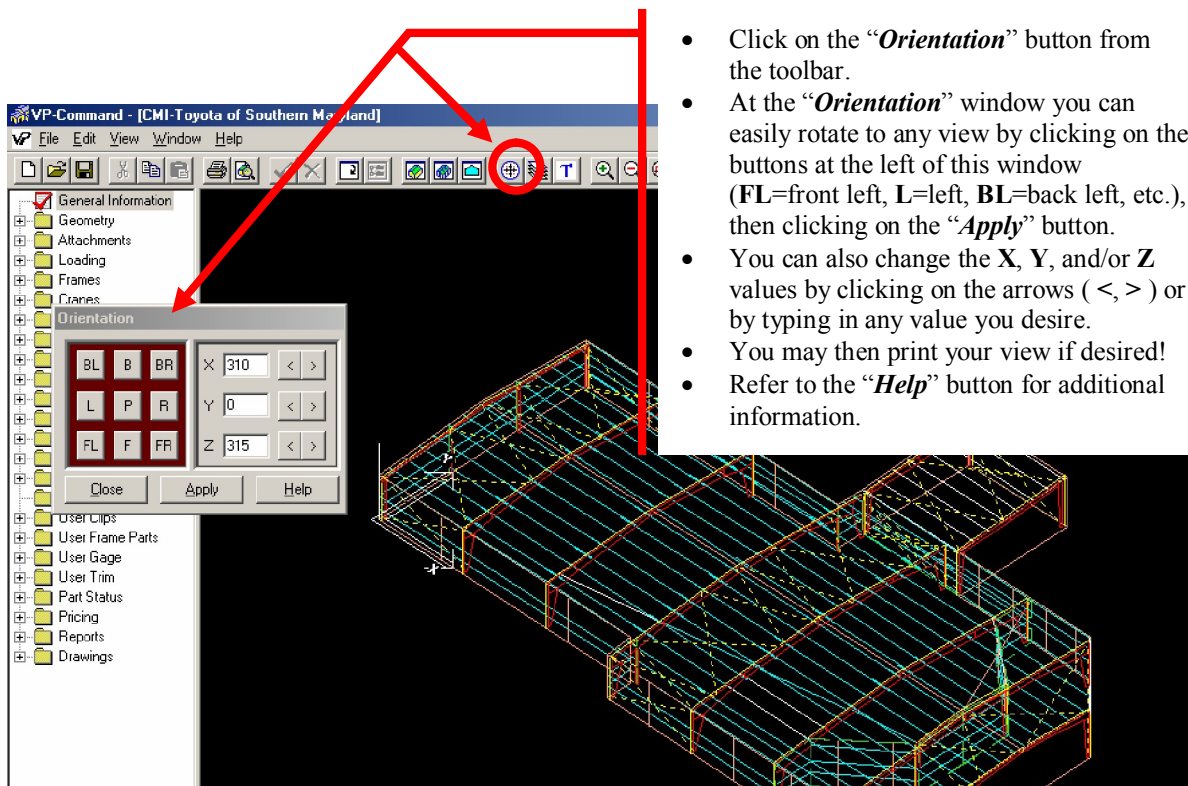

- Click on the “*Orientation*” button from the toolbar.
- At the “*Orientation*” window you can easily rotate to any view by clicking on the buttons at the left of this window (FL=front left, L=left, BL=back left, etc.), then clicking on the “*Apply*” button.
- You can also change the **X**, **Y**, and/or **Z** values by clicking on the arrows (<, >) or by typing in any value you desire.
- You may then print your view if desired!
- Refer to the “*Help*” button for additional information.

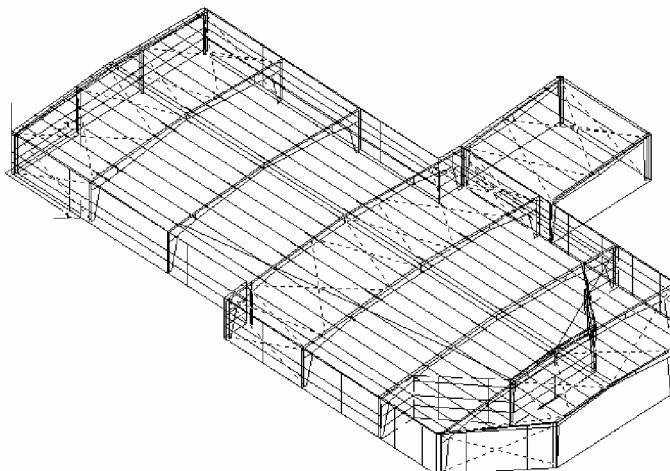

Printed View