



# VPC-TIP

October 26, 2001

## End 1 and End 2 of Framing Members

Ron English of the North Carolina Service Center generously donated this week's tip. It concerns the "End" designation of Primary Framing Members. Knowing which end is which will, for example, simplify the task of specifying depths of columns and rafter sections.

**End 1** is the *base* of a column or endpost, and the *ridge* or *highest* end of a rafter segment. **End 2** is the *opposite* end of this frame segment.

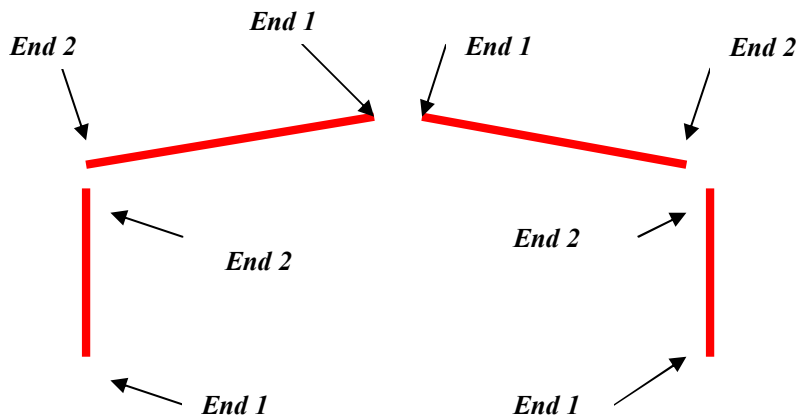
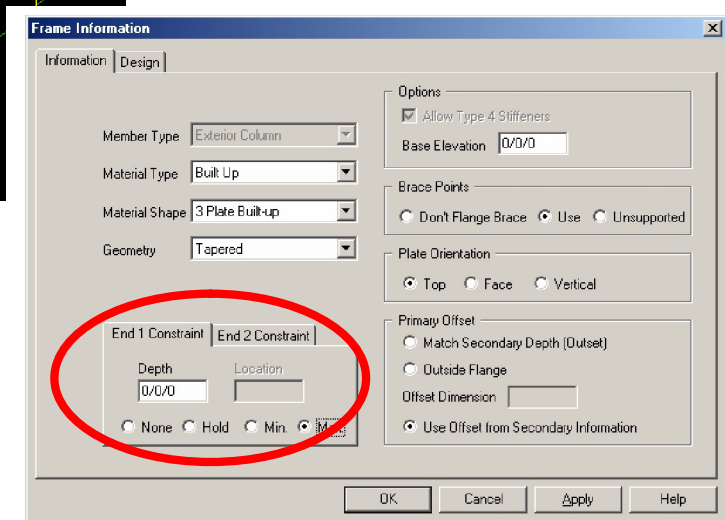
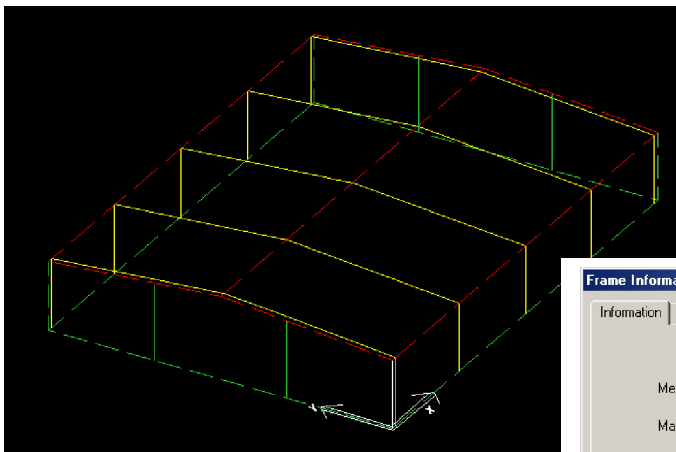

**Typical Frame**